

VANESSENTIAL

WALL MOUNTED STOW AWAY BAG

NOTE: These installation instructions apply to all three sizes of stow away bags

What's Included:



1X Stow Away Bag

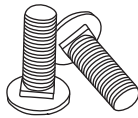

2X Bolts

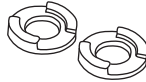

2X Lock Washers

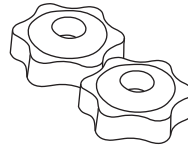

2X Plastic Knobs

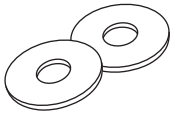

2X Metal Washers

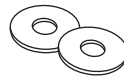

2X Rubber Washers

You Will Need:

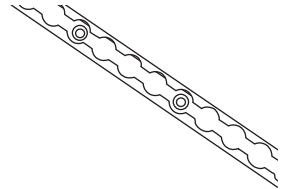

L-track installed in your van

1. Place the bolt onto the desired location on the Venture L-track. Place the lock washer over the top of the bolt followed by the rubber washer.

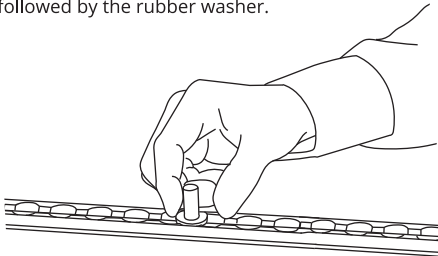

2. Hold up your Stow Away Bag to the bolt to measure out how far to place the second bolt on the Venture L-track.

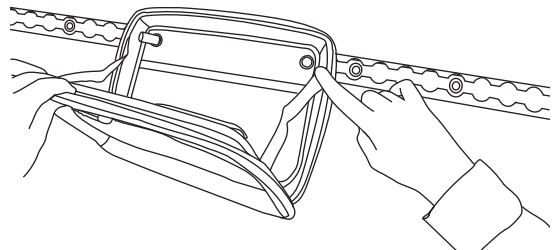

3. Place the second bolt onto the desired location, placing the lock washer on top followed by the rubber washer.

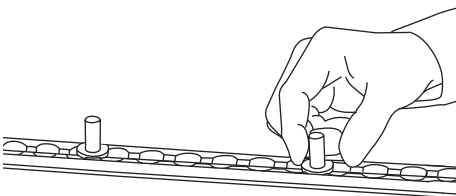

4. Line up the Stow Away Bag's eyelets on the back of the pouch to the bolts. Secure the pouch to the Venture L-track by placing a metal washer over the bolt, and then tightening the plastic knob into place.

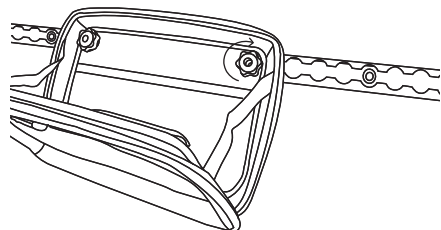

5. Pouches can be easily removed for on-the-go use and stored wherever needed.

